

NEW
275mm

The range continues to **GROW**

250mm

225mm

200mm

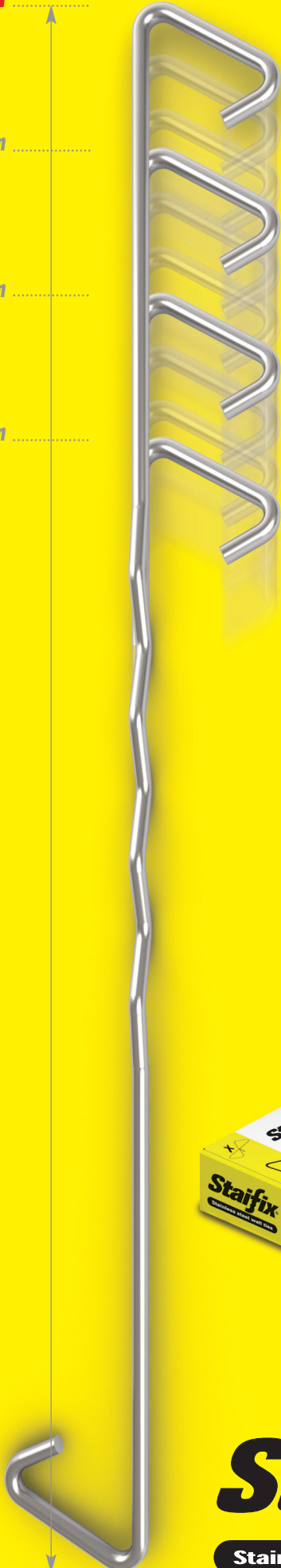

HRT4 Light Duty Wall Ties Type 4/Type A

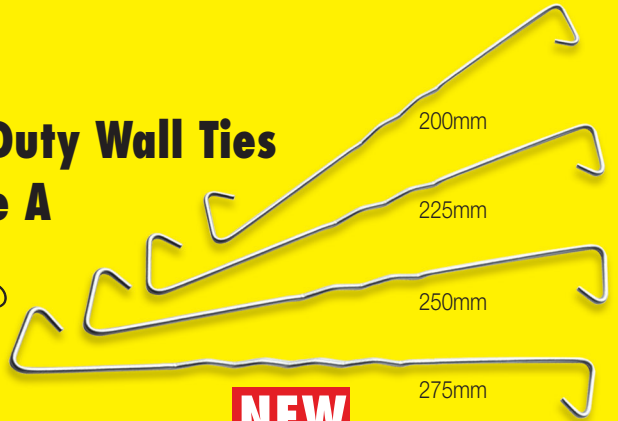
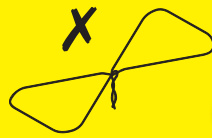

NEW

RT2 Medium Duty Wall Ties Type 2

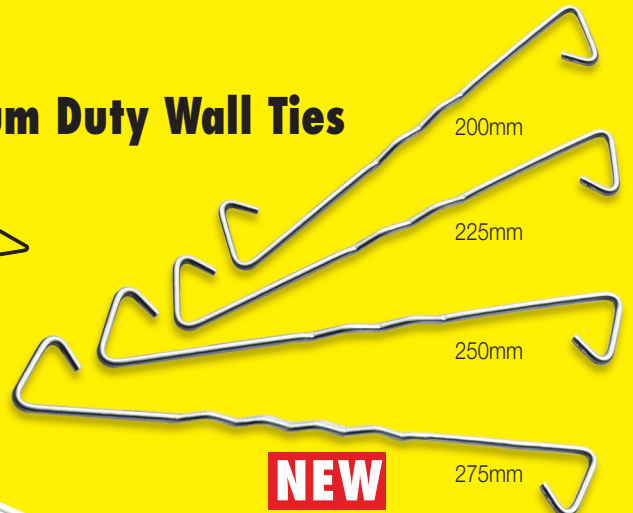

NEW



Staifix[®]
Stainless steel wall ties

Manufactured by

Ancon[®]
BUILDING PRODUCTS



THE QUEEN'S AWARDS
FOR ENTERPRISE:
INNOVATION
2012

Patents apply

Staifix Cavity Wall Ties

Wall Tie Selection to PD6697 & Approved Document E

Wall ties for use in external cavity walls should be selected by the 'Types' in PD6697. This document classifies wall ties by strength and use.

Wall ties for use in internal separating walls should comply with Approved Document E: Resistance to the passage of sound.

PD6697 Type 4 – Light Duty

Type 4 wall ties are suitable for use in the construction of houses, not greater than 10 metres in height. The Staifix HRT4 is a PD6697 Type 4 tie.

PD6697 Type 2 – Medium Duty

Type 2 wall ties are suitable for use in the construction of residential and commercial developments, not greater than 15 metres in height. The Staifix RT2 is a PD6697 Type 2 tie.

Approved Document E – Type A

Type A wall ties are suitable for use in the internal separating walls of new-build attached dwellings. The Staifix HRT4 is a Type A tie.

Restrictions may apply, see grid below.

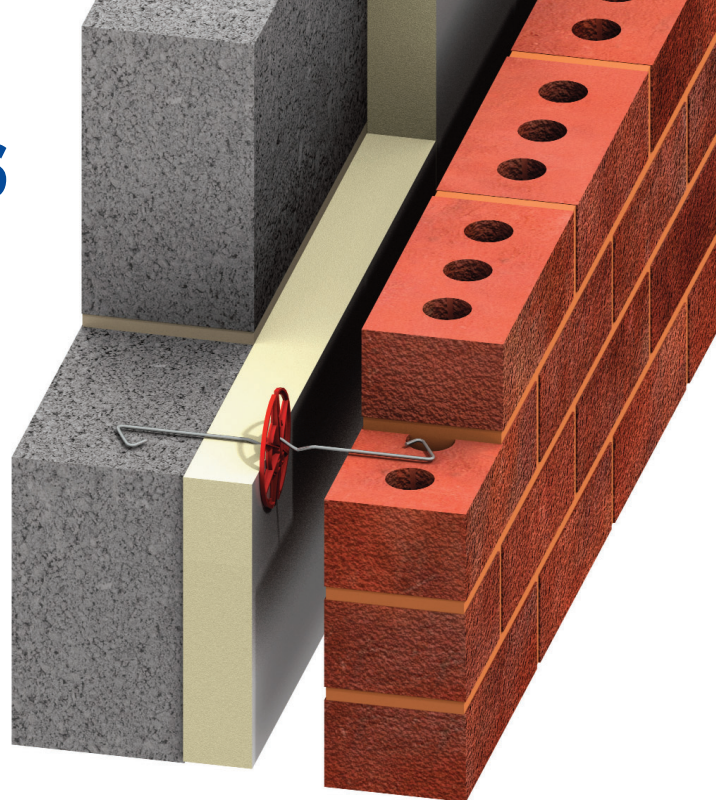

Now available to suit cavities from 50mm to 150mm

Staifix Wall Tie Selection Grid

Application	Cavity Width (mm)	50-75	76-100	101-125	126-150
					NEW
Internal separating walls of any height*		HRT4 200mm	HRT4 225mm	HRT4 250mm (125mm cavity only)	HRT4 275mm
External walls of houses not greater than 10 metres**		HRT4 200mm	HRT4 225mm	HRT4 250mm	HRT4 275mm
External walls of residential or small commercial developments not greater than 15 metres**		RT2 200mm	RT2 225mm	RT2 250mm	RT2 275mm

* Restrictions may apply to particularly tall buildings especially in the north western fringes of Scotland and Ireland and/or on exposed coastal sites.

** Flat sites with an altitude of no more than 150m above sea level and where the basic wind speed is up to 31m/s (BS EN 1991-1-4: 2005). For applications outside these parameters please contact your local Staifix stockist or call Ancon on +44 (0)114 238 1238. RT2 ties can be shown to be adequate for most projects through calculation.

Features of Staifix Cavity Ties

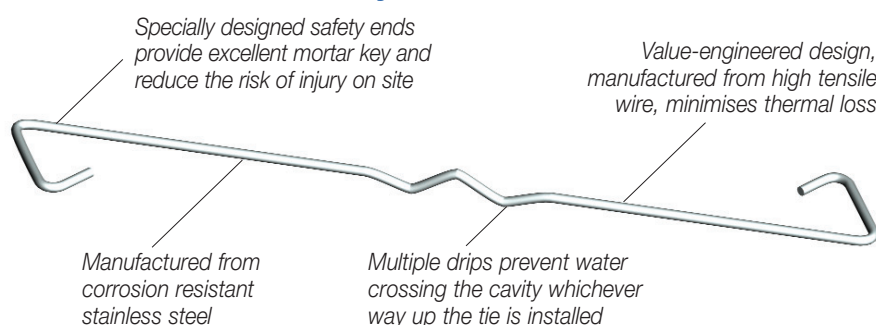

Packaging

Staifix ties are packed in bright, shallow, stackable boxes that simplify handling, storage and display. Merchandising units are available free of charge to Staifix stockists.

The box designs ensure HRT4 and RT2 wall ties are easily distinguishable, both in-store and on-site. This is particularly important to those constructing three storey attached dwellings, where both wall tie types may be required on the same site. RT2 ties are packed in a stripy box, which differs from the solid yellow band on the HRT4 box.



Installation Guidance

Wall ties should be used at not less than 2.5 per square metre (900mm horizontal and 450mm vertical centres) and preferably staggered over the wall area. This density may be varied by building regulations and should be increased to 3-4 per square metre at openings and unbonded edges.

Wall ties should be installed as the inner leaf is constructed. They should be pressed down in, and then surrounded by, fresh mortar. They should be positioned with a slight fall to the outer leaf and achieve an embedment of 62.5-75mm in each leaf. Installed ties should be clear of mortar droppings to allow the drips to function.

Ancon[®]
BUILDING PRODUCTS

Ancon Building Products

President Way, President Park, Sheffield S4 7UR
Tel: +44 (0) 114 238 1238
Email: info@ancon.co.uk
Visit: www.ancon.co.uk
Follow on Twitter @AnconUK